

# EXCAVATOR

## POST DRIVER



A convenient attachment for mounting your post driver on an excavator



	A	B	C	D	E	F	G	H	I	J	K	L	M	N	O	P	Q	R	S
	Welded Mount*	Yellow Plates	Domed Tool**	Flat Tool**	Rock Spike	Concrete Point	Chain	Nitrogen Bottle	Nitrogen Charge Kit	Hydraulic Hoses	Price	Working Weight	Shipping WxLxH	Excavator Weight	Oil Flow	Min PSI	Blow Rate	Shaft Diameter	Standard Tool ID
<b>350E</b>	✓	✓	✓**	**			✓		✓	✓	\$4,400	310	18x30x24	2,000-10,000 lb	5-20	1300	600-1100	1.95"	4 3/8"
<b>400E</b>	✓	✓	✓**	**	✓	✓	✓	✓	✓	✓	\$6,500	450	28x48x30	5,500-10,000 lb	7-13	1300	600-1100	2.12"	6"
<b>750R</b>	✓	✓	✓**	**	✓	✓	✓	✓	✓	✓	\$6,800	800	28x48x30	8,000-14,000 lb	11-18	2000	500-900	2.7"	7"
<b>1000E</b>	✓	✓	✓**	**	✓	✓	✓	✓	✓	✓	\$8,000	825	28x48x30	12,000-18,000 lb	13-24	2200	400-800	3"	8"
<b>1500E</b>	✓	✓	✓**	**	✓	✓	✓	✓	✓	✓	\$11,000	1310	28x57x36	14,000-28,000 lb	16-27	2300	400-800	3.35"	9"

\* Price includes standard excavator mount. See back side for mounts with up-charge.  
 \*\* East of the Mississippi, driver is shipped with flat tool.



Metric ÷ 25.4 = English  
 Ex: 45mm ÷ 25.4 = 1.77 in.

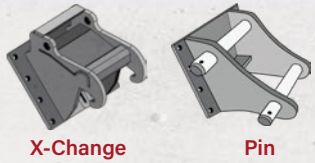

X-Change

Pin

### Bobcat Mounts

Model	Compatibility
HMQ 100	X-Change E10, 20, 32, 35, 42, 50, 60, 88, 145, 165, 325, 328, 331, 341, 435
HMP 123	E80/85
HMP 123R	E85R



Pin

### CAT Mounts

Model	Compatibility
HMP 044	303/303.5/304
HMP 100	304/305
HMP 034	305CR/305.5/306
HMP 127	307C/308/308C
HMP 098	307D/308D/308E
HMP 049	311
HMP 040	320
HMP 058	420 (Backhoe)

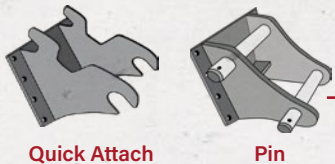

Quick Attach

Pin

### John Deere Mounts

Model	Compatibility
HMQ 011	27/35 Quick Attach
HMQ 019	50/60 Quick Attach
HMP 027	75/85 Pin
HMP 066	310/410 (Backhoe)



Quick Attach

Pin

### Kubota Mounts

Model	Compatibility
HMQ 002	KX40/41/91/121/U35 Quick Attach
HMQ 006	KX161/U45 Quick Attach
HMQ 010	KX057/U55 Quick Attach
HMQ 008-RI	KX080 Quick Attach
HMP 008	KX080 Pin



Pin

### Komatsu Mounts

Model	Compatibility
HMP 026	35
HMP 027	60/75/78/80/88/90/95
HMP 069	100/120/128/138

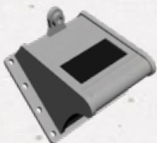

Quick Attach

### Wain-Roy Mounts

Model	Compatibility
W27	HMW27 1-1/4"
W30	HMW30 1-3/4"



Pin

### More Mounts

Model	Compatibility
HMP 141	Dosan DX63
HMP 101	Case 580-L-K-M
HMP 044	Case CX37/New Holland E37
HMP 157	Case CX57/New Holland E57/61
HMP 8040	JCB 8040
HMP 033	Takeuchi 175W/180FR/280/290
HMP 148	Takeuchi TD260
HMP 102	Volvo ER45/50/58
HMP 039	Yanmar VOI 27, 35/Gehl Z27,35/ Mustang 350Z
HMP 118	Yanmar VOI 40, 45, 50, 55/ Mustang 450A
Blank Plate	Excavator Mount Blank Plate

Hose Length	Weight	Pin A & A2		Gap B & B2		Center Line		Price	Up-charge
		(mm)	(in)	(mm)	(in)	(mm)	(in)		
10'	110	-	-	-	-	-	-	\$1,650	\$0
10'	137	45	1.772	200	7.874	291	11.457	\$1,650	\$0
10'	146	55	2.165	200	7.874	291	11.457	\$1,650	\$0

8'	99	40	1.575	135	5.315	200	7.874	\$1,650	\$0
8'	113	40	1.575	156	6.142	260	10.236	\$1,650	\$0
8'	115	45	1.772	156	6.142	260	10.236	\$1,650	\$0
8'	167	45	1.772	186	7.323	306	12.047	\$1,650	\$0
8'	150	50	1.969	200	7.874	306	12.047	\$1,650	\$0
8'	148	65	2.559	222	8.740	407	16.024	\$1,650	\$0
8'	613	80	3.150	311.15	12.250	444.5	17.500	\$3,600	\$1,950
8'	144	45/50	1.772/1.969	206/256	8.110/10.079	345	13.583	\$2,200	\$550

8'	94	-	-	-	-	-	-	\$1,650	\$0
10'	108	-	-	-	-	-	-	\$1,650	\$0
8'	141	50	1.969	200	7.874	310	12.205	\$1,650	\$0
8'	123	54.61/49.53	2.150/1.950	207	8.150	304	11.969	\$2,200	\$550

8'	97	-	-	-	-	-	-	\$1,650	\$0
8'	108	-	-	-	-	-	-	\$1,650	\$0
8'	95	-	-	-	-	-	-	\$1,650	\$0
8'	209	-	-	-	-	-	-	\$2,200	\$550
8'	282	60	2.362	204	8.031	296	11.654	\$2,200	\$550

8'	103	35	1.378	145	5.709	194	7.638	\$1,650	\$0
8'	141	50	1.969	200	7.874	310	12.205	\$1,650	\$0
8'	321	60	2.362	260	10.236	374	14.724	\$2,200	\$550

8'	118	-	-	-	-	-	-	\$2,200	\$550
8'	250	-	-	-	-	-	-	\$2,200	\$550

8'	113	45	1.772	155	6.102	260	10.236	\$1,650	\$0
8'	220	44.5	1.752	254	10.000	354	13.937	\$2,500	\$850
8'	99	40	1.574	135	5.314	200	7.874	\$1,650	\$0
8'	138	45	1.771	165	6.496	285	11.220	\$1,650	\$0
8'	130	40	1.575	159	6.260	343	13.504	\$1,650	\$0
8'	145	50	1.969	165	6.496	292	11.496	\$2,500	\$850
8'	116	45	1.772	166	6.535	248.5	9.783	\$2,200	\$550
8'	139	40	1.575	160	6.299	220	8.661	\$2,200	\$550
8'	95	37.8	1.488	142	5.591	213	8.386	\$1,650	\$0
8'	148	45	1.772	165	6.496	270	10.630	\$2,200	\$550
-	50	-	0.75	-	14	-	16	\$220	\$0

### How to Measure

- A/A2: Pin
- B/B2: Gap
- C: Center Line

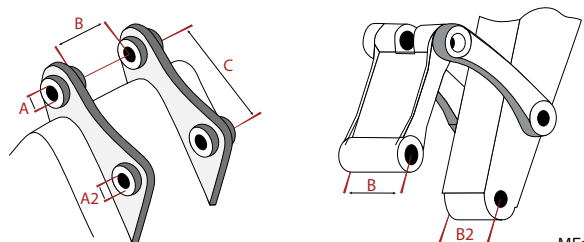

800-330-1937  
 www.montanapostdriver.com  
 Gold Creek, Montana